



# **Feasibility Study Update**

**HMFH** Architects, Inc.

# **Educational Vision**

- **Integrate CTC and Academic as much as practical**
- **Foster relationships**
- **Flexible (Future Proof)**
- **Student centered**
- **Staff professional development**

# Facility Concepts

- **Small Learning Communities**

9<sup>th</sup> Grade Academy with either:  
Thematic 10-12 SLCs or  
Interdisciplinary 10-12 SLCs

or

Interdisciplinary 9-12 SLCs



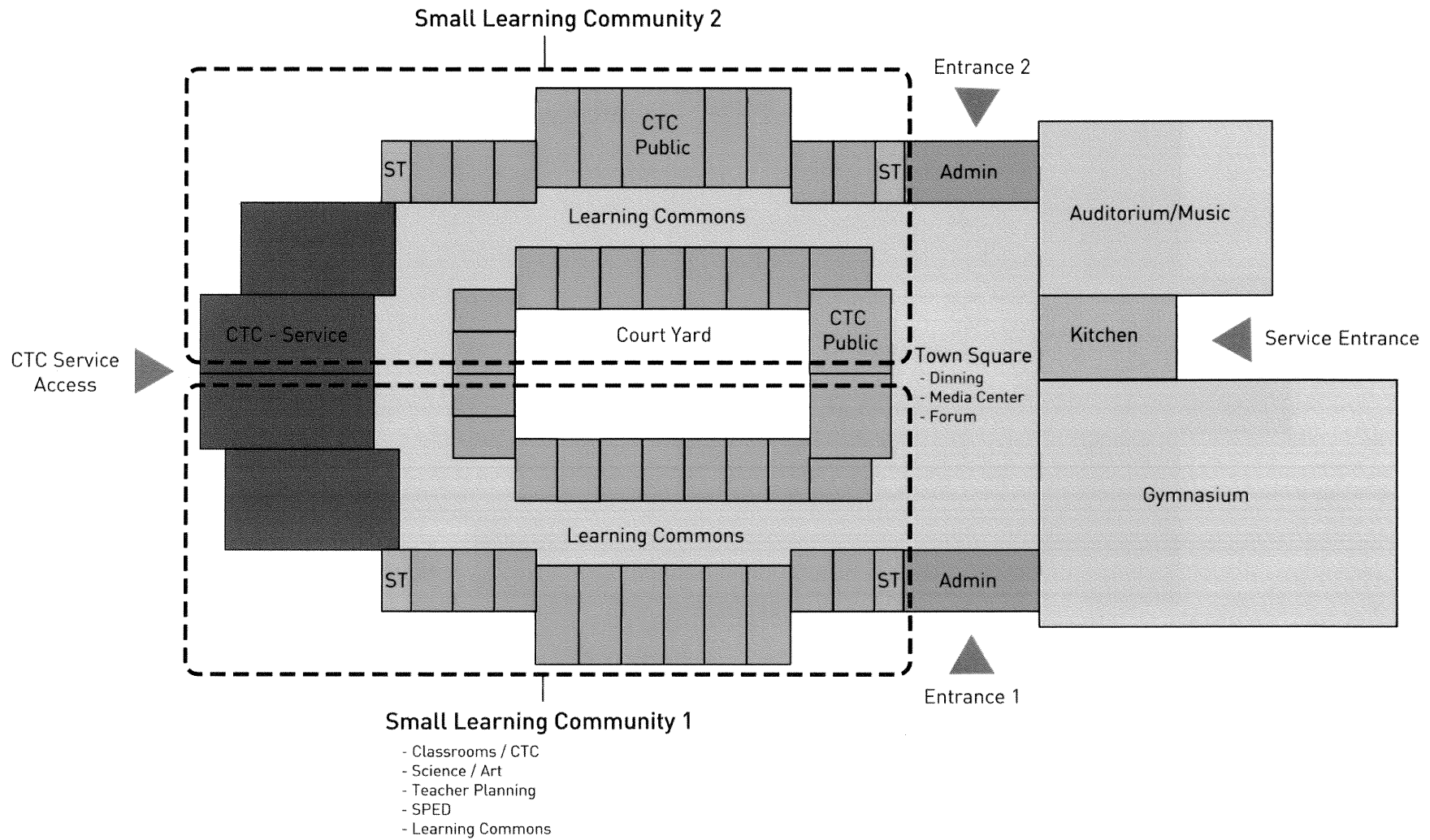

## Small Learning Community with Integrated CTC

Dover High School & Career Tech Center



# Schedule Review

17

	16-Feb	23-Feb	2-Mar	9-Mar	16-Mar	23-Mar	30-Mar	6-Apr	13-Apr	20-Apr	27-Apr	4-May	11-May	18-May	25-May	1-Jun	8-Jun	16-Jun
<b>JBC Meetings</b>	○		○		○		○	○	○	○	○	○	○	○	○	○	○	○
<b>Site and Building Assessment</b>																		
Team Site and Building Tour																		
Draft Report																		
Review with JBC																		
Final Report		○																
<b>Educational Planning</b>																		
Visioning Sessions																		
Tours of Other Schools?																		
Teacher's Interviews																		
Draft Report/Educational Plan																		
Draft Space Program																		
Review Draft Report w JBC	○				○													
All Faculty review		○				○												
Final presentation to JBC			○			○												
Final presentation to SC			○			○												
Community Meeting(s)?				○		○	○											
<b>Site Option Studies</b>																		
Develop Reno and New Options																		
Review with JBC							○	○										
Refine Options																		
Review with JBC - Narrow to 3									○	○								
Sustainable Goals Meeting										○	○							
Dover Agency Meetings										○	○							
Community Meeting(s)?													○					
Final Options with Cost Estimates															○	○		
JBC Approval															○	○		
School Committee Approval															○	○		
City Council Review																	○	○

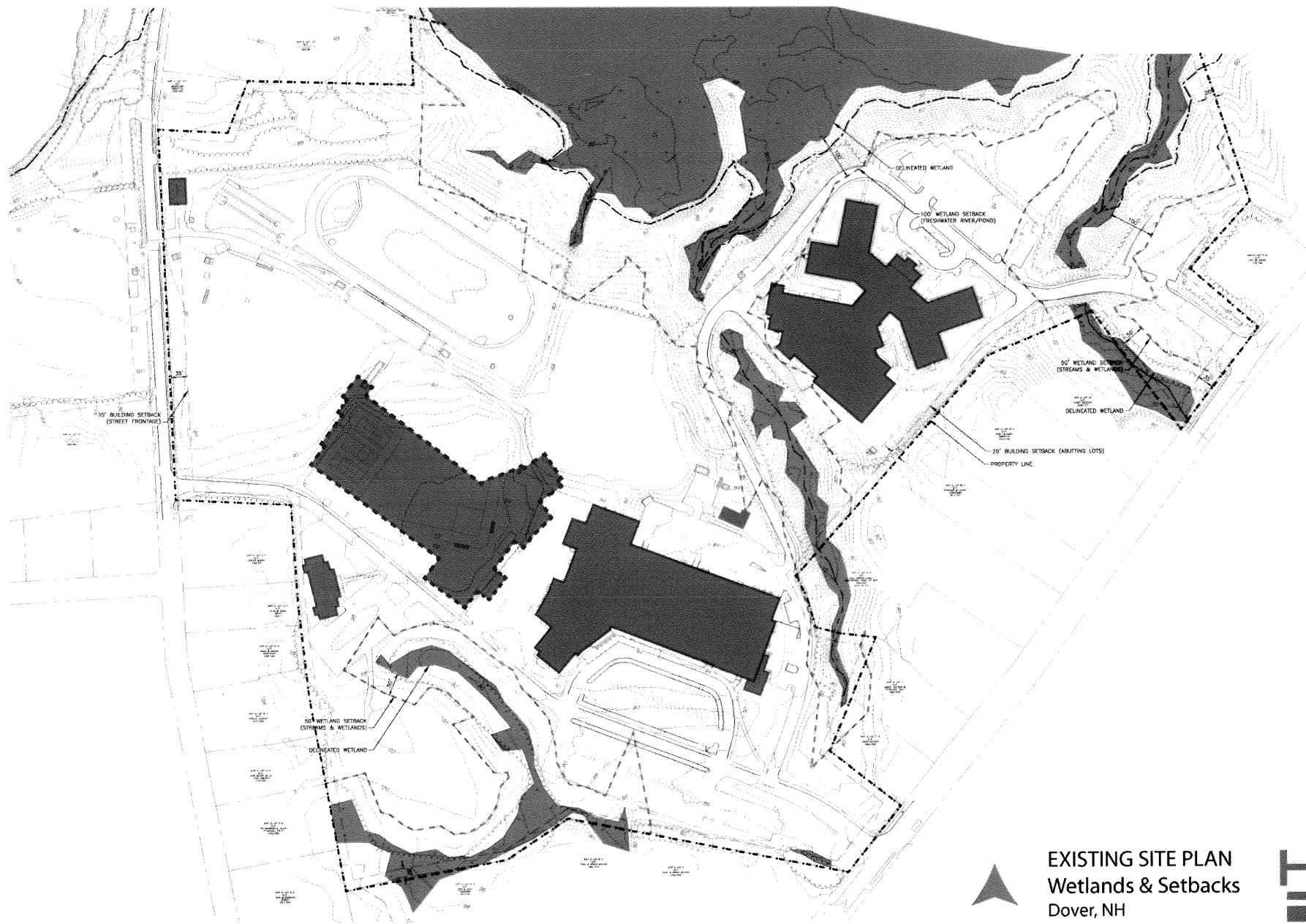

EXISTING SITE PLAN  
Wetlands & Setbacks  
Dover, NH

